

	PART DESCRIPTION	MATERIAL
①	SM1RR	ANODIZED ALUMINUM
②	BX1254-500-C	N-BK7
③	SM1L6-A	ANODIZED ALUMINUM

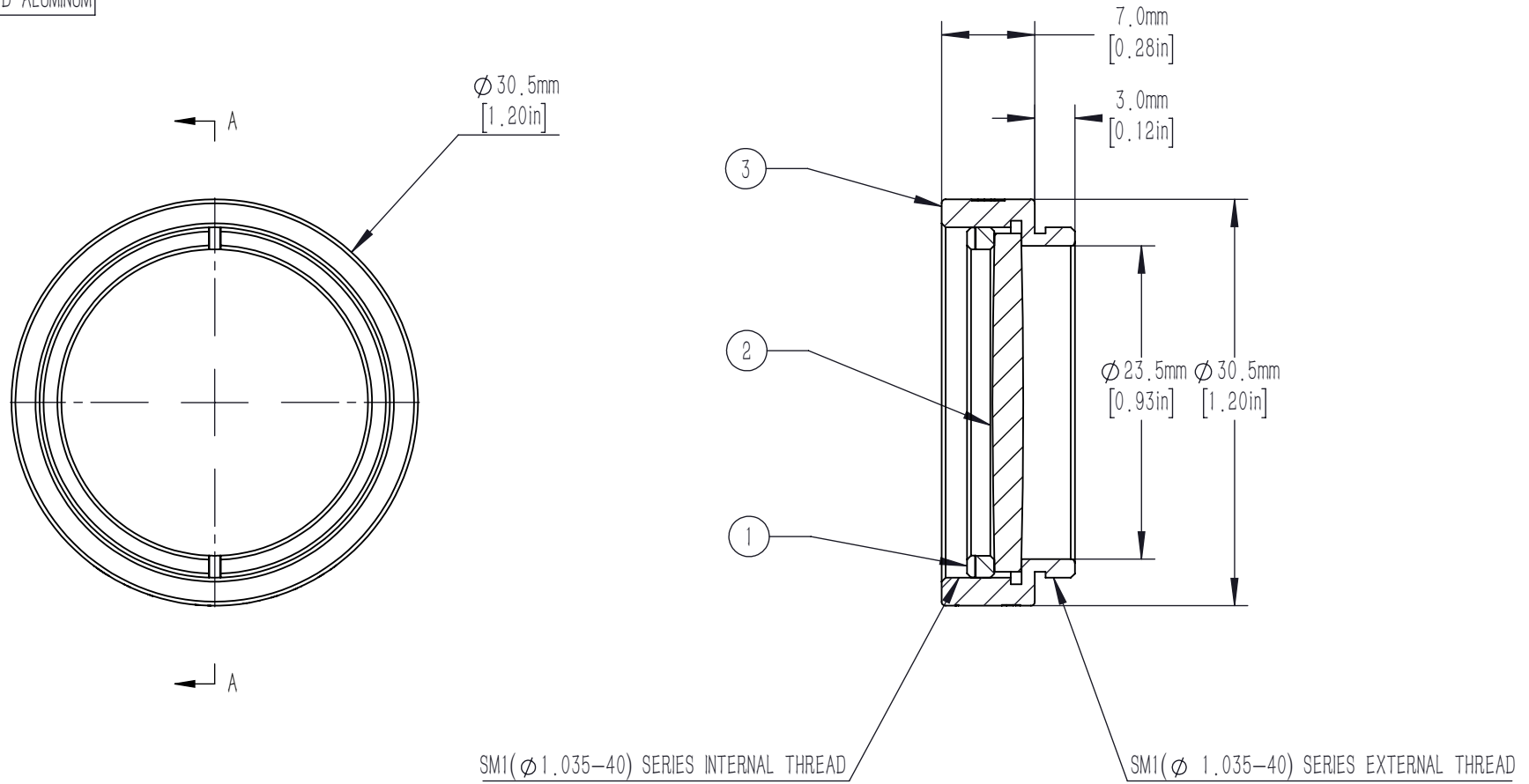

#### NOTES/SPECIFICATIONS:

1. WORKING WAVELENGTH: 1050nm-1700nm
2. FOCAL LENGTH:  $f=500.0\text{mm} \pm 1\%$
3. CLEAR APERTURE 90% Of Diameter
4. SURFACE QUALITY: 40/20
5. DESIGN WAVELENGTH: 587.6nm
6. COATING:  $R_{\text{avg}} < 0.5\% @ 1050-1700\text{nm}$

FOR INFORMATION ONLY NOT FOR  
MANUFACTURING PURPOSES

DRAWING PROJECTION						
	NAME	DATE				
			Mounted N-BK7 Bi-Convex Lens, D25.4 , F= 500mm, -C			
DRAWN	CWD	2022/5/18	EX1254-500-C-ML			
APPROVAL	ZSE	2022/5/18	MATERIAL	WEIGHT	SCALE	REV
FOR INFORMATION ONLYNOT FOR MANUFACTURING PURPOSES			N/A	0.009kg	4:1	A